

## AUTO-BALER

The Auto-Baler packs consumer bags into paper, poly, and mesh master bags. It counts packages entering into each master bag, and once finished, it closes with glue or a sewing head. A vertical lift provides gentle handling by catching bags and reducing drops as they enter into master bags.

The Auto-Baler is capable of packing up to 20 pound consumer bags and can pack at a rates of up to nine bales per minute. An overhead bypass can be purchased to bypass the baling process, which allows operators to send bags to bins or packing table.

### FEATURES

- Vertical lift for gently adding consumer bags to master bag
- Robust, strong frame
- Uses industrial gluing head
- Requires little floor space
- Left and right-hand versions to fit layout
- Easy access for service and maintenance
- User-friendly program allows operators to create setups with ease
- Clear doors around machine for both safety and easy viewing of internal parts of machine
- Optional router for remote assistance

### ADDITIONAL OPTIONS

- Overhead bypass to redirect bags into bins or packing table
- Gusset folding device
- Seal unit for poly bags
- Vibrating motor in support belt
- Bin mode (slide to be installed under filling head)
- Hugging belt
- V-Shaped belt

### PARTNER EQUIPMENT

- Single Wicket Bagger
- Dual Wicket Bagger
- Clipper
- Carousel
- Rollstock Poly Bagger
- Rollstock Mesh Bagger
- Vertical Form, Fill, & Seal



### CONSUMER PACK WEIGHT RANGE

1 to 20 pounds

### CONSUMER PACK SPECS

#### Paper

- Min. 9.2"(233mm) W x 14.3"(363mm) L x 32"(813mm) H
- Max. 9.2"(233mm) W x 15.4"(390mm) L x 36"(915mm) H

#### Poly

- Min. 21"(533mm) W x 32"(813mm) H
- Max. 21"(533mm) W x 36"(915mm) H

### CAPACITY / RATE

10 pound consumer bags  
up to 9 bales per minute\*

### AIR CONSUMPTION

12 CFM\*\*

### POWER

230 Volt, 3 Phase and Ground

\*\* Actual air consumption will increase based on discharge system(s) chosen.

AUTO-BALER

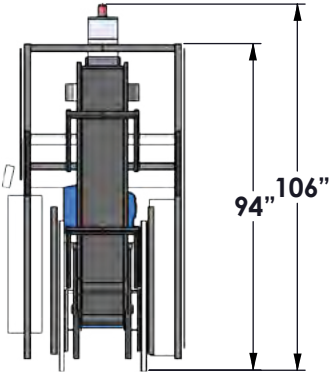
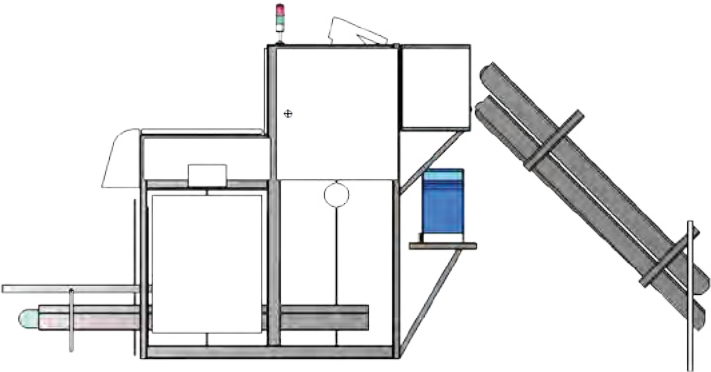
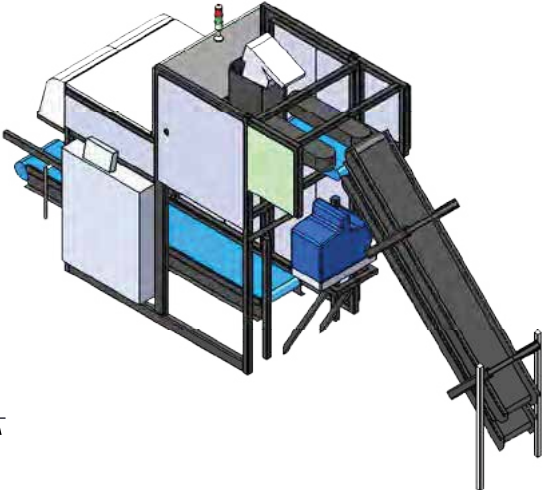
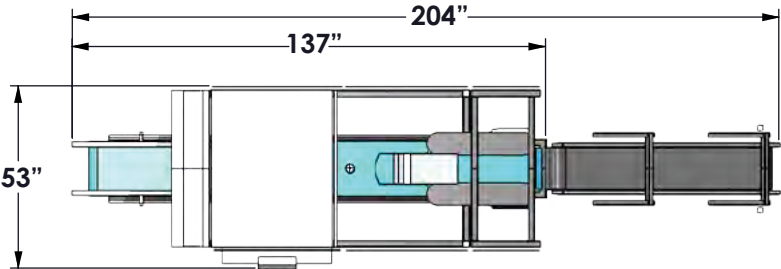

Measurements are rounded off to the nearest inch.